

Foster -
Luzerne

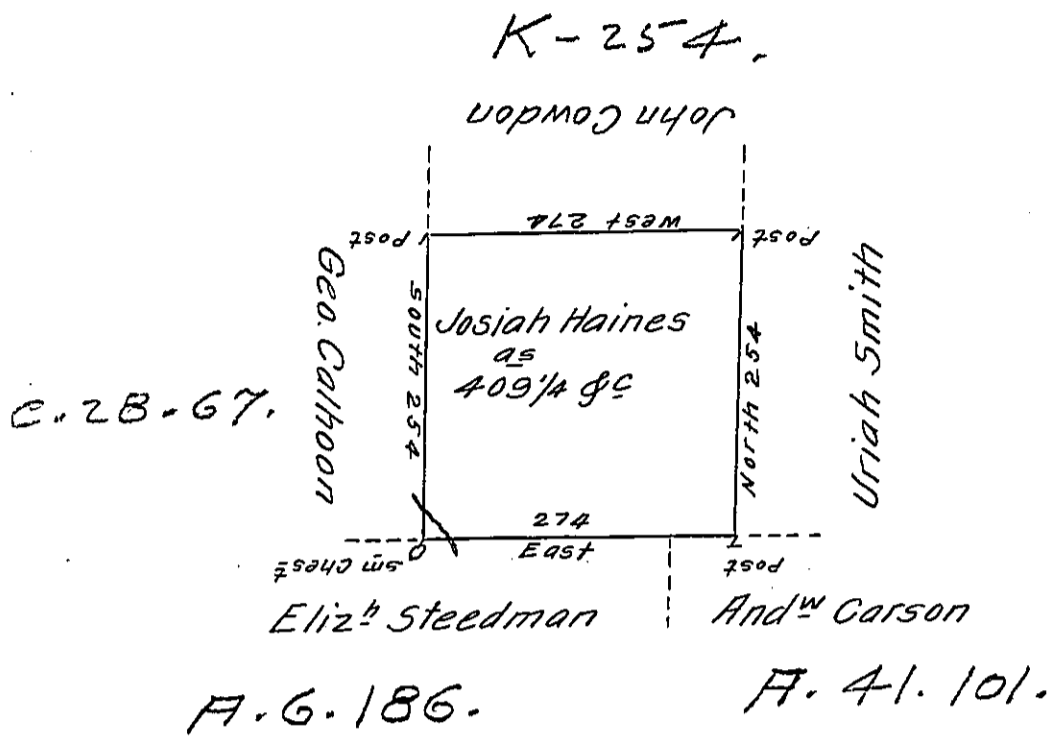

A Draft of a tract of land Called — Situate Joining Land Surved
for John Cowdon & others in the County of Northum^d Containing
four hundred and Nine Acres $\frac{1}{4}$ & Allow^e. Surveyed for Josiah
Haines the 9th day of Sep^r 1793 by Virtue of a Warrant dated 13th
day of June 1793.

To by W^m Gray D. S.
Daniel Brodhead Esq^r }
Surv^r Gen^l }

IN TESTIMONY that the above is a copy of the original remaining on file in
the Department of Internal Affairs of Pennsylvania, made
conformably to an Act of Assembly approved the 16th day of
February, 1833, I have hereunto set my Hand and caused
the Seal of said Department to be affixed at Harrisburg,
this twenty first day of March 1911.

Mary Fouck
Secretary of Internal Affairs.